



120-16 shown in Satin Aluminum

120-13 120-16 120-24

LUMINOUS BOWL

Design
Sustainability
Value



print this page



email this page to a colleague



installation instructions



interactive submittal drawings

COMPANION



FEATURES

- Simple shallow bowl design.
- T-5 circline lamps provide uniform luminosity.
- Available in three sizes.
- Tool-free relamping.

ECO INFO

METALS: Aluminum and brass with the highest available recycled content for lower embodied energy. Both metals are valuable and recyclable at the end of the product's useful life. For more information see "GENERAL INFO"

FINISHING: Aluminum and Antique Brass finishes are sealed with a hand-applied bees wax. No paint or lacquer is used in order to avoid pollution associated with the manufacture and application of these substances. Satin Brass is clear-coated with a very low VOC water-based coating. Paint finishes are low VOC and oven cured.

ENERGY: Designed exclusively for circline fluorescent lamps using HPF electronic ballasts.

MATERIALS

- Solid brass or aluminum metal work, hand finished
- Luminous bowl is white acrylic with a matte finish.

FINISHES

- SAL** Satin Aluminum
- SB** Satin Brass
- AB** Antique Brass
- CCP** Custom Color Painted finish

Standard metal finishes are hand satined and either waxed or sealed with a water-based clear coat. Other metal finishes are available. Contact factory.

LAMPING

120-13: 1-T5 22W Circline
120-16: 1-T5 40W or 55W Circline
120-24: 4-CF27 or 39W, 2G11 base.
Lamp not included.

BALLAST

Integral electronic HPF, 120V/277V.
See "GENERAL INFO" for more detail.





120-16 Shown with EBP and collar.

120-13
120-16
120-24

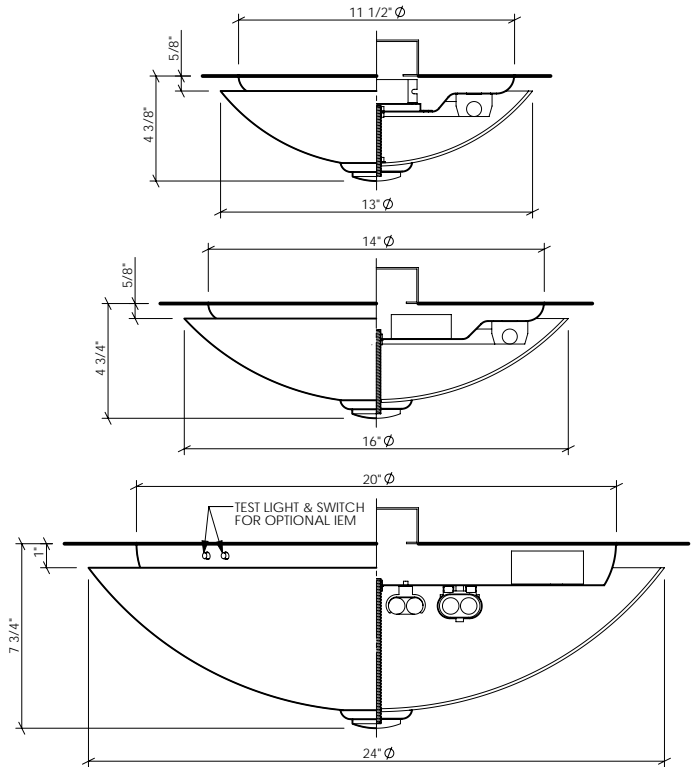

OPTIONS

FAUX: Hand applied faux alabaster finish available, specify **FAUX**.

DIMMING: Electronic dimming ballast available.

EMERGENCY BATTERY PACK: Integral **EBP** with addition of 1 1/4 inch deep collar available for 120-16. (No collar required for 120-24.) Specify **IEM**. For 120-12 EBP is remote mounted. Specify **REM**.

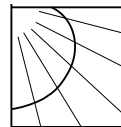

PHOTOMETRICS
 Use Lighting Sciences Report 22410 for the model 106.
 Fixture Efficiency: 80.6%

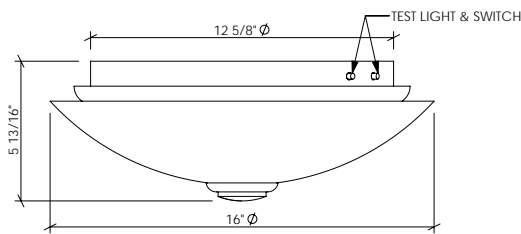
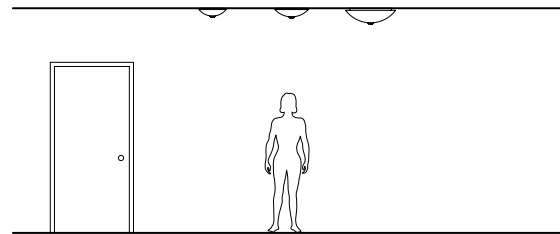

EBP CONFIGURATION

MOUNTING: Standard J-box or plaster ring.

WEIGHT: 120-13: 3lbs
 120-16: 4lbs
 120-24: 6lbs

VARIATIONS / MODIFICATIONS

- Special finishes
- Addition of decorative detail
- Different bowl size

SPEC GUIDE SAMPLE SPEC: 120-16-T5/40-120-SAL-FAUX

CAT#	SIZE	LAMPING	VOLT	FINISH	OPTION
<input type="checkbox"/> 120	<input type="checkbox"/> 13	<input type="checkbox"/> T5/22	<input type="checkbox"/> 120	<input type="checkbox"/> SAL	<input type="checkbox"/> FAUX
	<input type="checkbox"/> 16	<input type="checkbox"/> T5/40	<input type="checkbox"/> 277	<input type="checkbox"/> AB	<input type="checkbox"/> IEM
	<input type="checkbox"/> 24	<input type="checkbox"/> T5/55		<input type="checkbox"/> SB	<input type="checkbox"/> REM
		<input type="checkbox"/> CF4/27		<input type="checkbox"/> CCP	
		<input type="checkbox"/> CF4/39			

