



Shown in matte white finish.



110

LUMINOUS BOWL



Design
Sustainability
Value

FEATURES

- Simple clean design.
- Available in 13" & 17" dia.
- Tool-free relamping.

ECO INFO

ENERGY: Designed exclusively for compact fluorescent lamps.

MATERIALS

- Cold rolled steel body.
- Luminous bowl is white acrylic

FINISHES

MW Matte White

SNK Satin Nickel

CCP Custom Color Painted finish

LAMPING

13": 1-T5 22W circline.

17": 1-T5 40W or 55W circline.

Lamps not included.

BALLAST

Integral electronic NPF, 120V. HPF available.

See "GENERAL INFO" for more detail.



13" Shown in Satin Nickel.



17" Shown in Matte White.

110

LUMINOUS BOWL

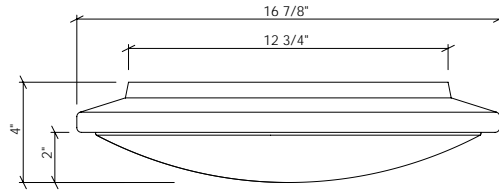
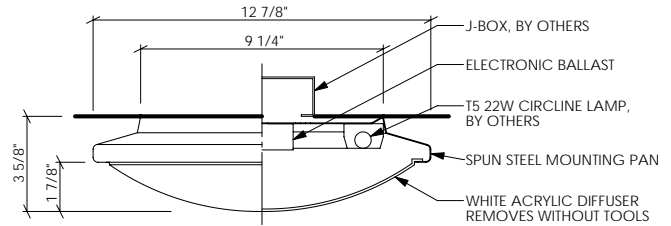

LAMPING: 1- T5/40W, 1- T5/55W

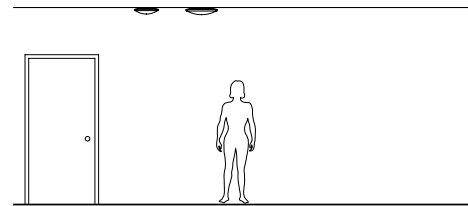

OPTIONS

NORMAL POWER FACTOR BALLAST: This fixture is supplied with a 120 volt NPF ballast. For HPF add the suffix as follows: 120HPF.

NOTE: HPF is standard for 277 volt.

EMERGENCY BATTERY PACK: Remote mounted EBP, specify REM.

MOUNTING: Standard J-box or plaster ring.

WEIGHT: 3 lbs

SPEC GUIDE

SAMPLE SPEC: 110-13-T5/22-120-MW

CAT#	SIZE	LAMPING	VOLT	FINISH	OPTION
<input type="checkbox"/> 110	<input type="checkbox"/> 13"	<input type="checkbox"/> T5/22	<input type="checkbox"/> 120	<input type="checkbox"/> MW	<input type="checkbox"/> REM
	<input type="checkbox"/> 17"	<input type="checkbox"/> T5/40	<input type="checkbox"/> 120HPF	<input type="checkbox"/> CCP	
		<input type="checkbox"/> T5/55	<input type="checkbox"/> 277HPF	<input type="checkbox"/> SNK	

